

STAGE 10

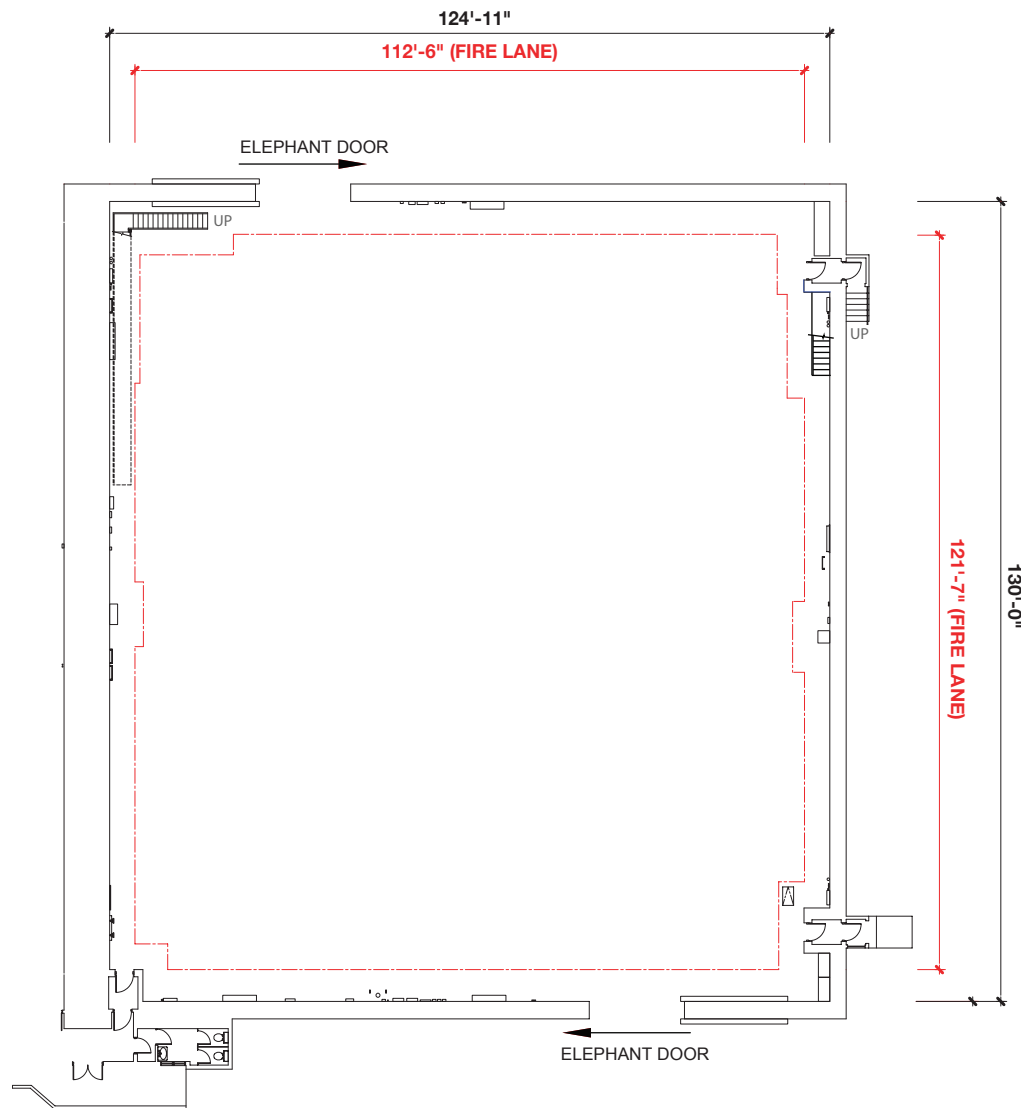

STAGE SIZE:

(125' x 130') 16,250 sq. ft.*

LIVE LOAD CAPACITY OF FLOOR:

Uniform Distribution = 250 PSF
Concentrated on Min. 2' x 2' area = 3500 lbs.
(Engineered Drawings Available Upon Request)

HEIGHT:

40' to the permanents with catwalks above

FALL PROTECTION:

100% Tie-off Horizontal Lifeline system

ELECTRICAL:

A.C. Prod. Lighting: 7200/2400 amps

Basic Building Power: 400 amps
120/240 volts
Single Phase

Power for Equipment: 3 Phase:
200 amps
240 volts**

**Local 40 tie-in required

D.C. Lighting: Available upon request

ELEPHANT DOORS:

Two entrances approx:

16' Wide x 22' High

Loading Height:

Street Level & Loading Dock

HVAC:

Silent air conditioning and heating

WATER:

On four perimeter walls

*Stage dimensions to be field verified

Downloadable PDF available at
www.foxstudiolot.com/stage

FOX PRODUCTION SERVICES

10201 W. Pico Blvd, Los Angeles, CA 90064

310-FOX-INFO | foxinfo@fox.com | www.foxstudiolot.com

™ & © 2019 Fox and its related entities. All rights reserved.

FOX