

# STAGE 18

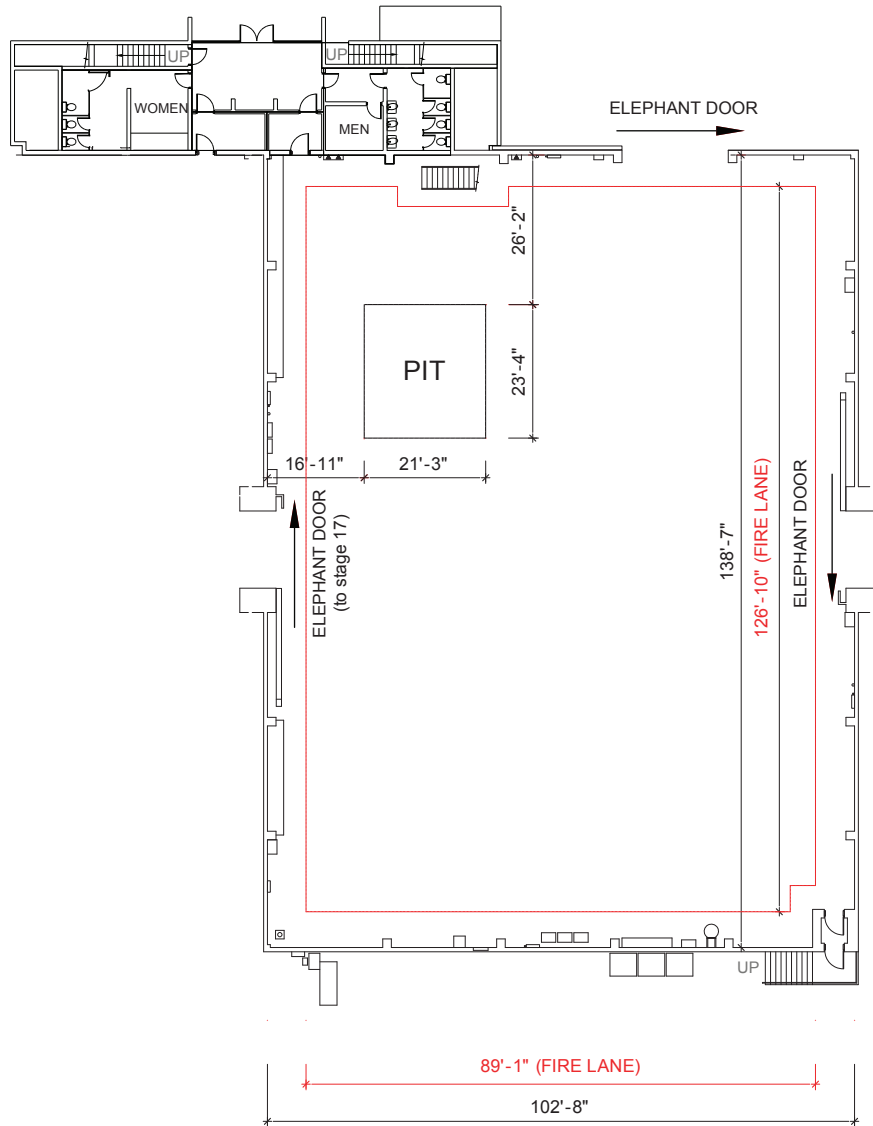

## STAGE SIZE:

(102' x 138') 14,076 sq. ft.\*  
Audience rated A-3  
Maximum crew & audience = 299

## LIVE LOAD CAPACITY OF FLOOR:

Wood floor over concrete

## HEIGHT:

35' to the permanents with catwalks above

## FALL PROTECTION:

100% Tie-off Horizontal Lifeline system

## ELECTRICAL:

A.C. Prod. Lighting: 6000/2000 amps  
120/208 volts

Basic House/Bldg Power: 450 amps  
120/240 volts  
Single Phase

Power for Equipment: 3 Phase:  
300 amps  
240 volts\*\*  
\*\*Local 40 tie-in required

## ELEPHANT DOORS:

One entrance:  
18' Wide x 24' High

## WATER:

On four perimeter walls

# FOX

\*Stage dimensions to be field verified

Downloadable PDF available at  
[www.foxstudiolot.com/stage](http://www.foxstudiolot.com/stage)

## FOX PRODUCTION SERVICES

10201 W. Pico Blvd, Los Angeles, CA 90064

310-FOX-INFO | [foxinfo@fox.com](mailto:foxinfo@fox.com) | [www.foxstudiolot.com](http://www.foxstudiolot.com)

™ & © 2019 Fox and its related entities. All rights reserved.

# FOX