

# STAGE 5

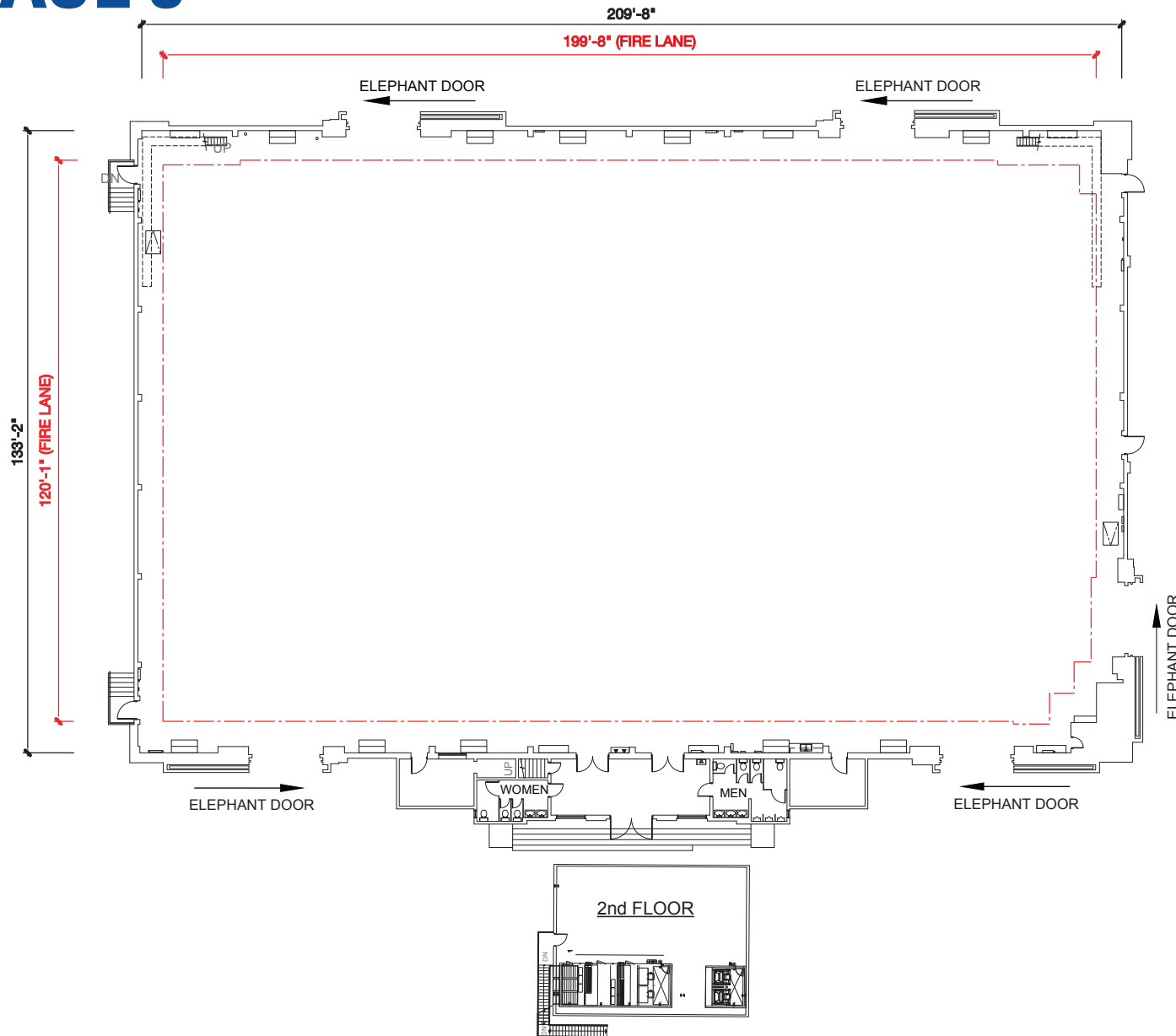

**STAGE SIZE:**  
(133' x 210') 27,930 sq. ft.\*

**LIVE LOAD CAPACITY OF FLOOR:**  
Uniform Distribution = 200 PSF  
Concentrated on Min. 2' x 2' area = 2000 lbs.  
(Engineered Drawings Available Upon Request)

**HEIGHT:**  
40' to the permanents with catwalks above

**FALL PROTECTION:**  
100% Tie-off Horizontal Lifeline system

**ELECTRICAL:**  
A.C. Prod. Lighting: 9000/3000 amps  
120/208 volts  
Basic House/Building Power: 200 amps  
120/240 volts  
Single Phase

Power for Equipment: 3 Phase:  
200 amps  
240 volts\*\*  
\*\*Local 40 tie-in required

D.C. Lighting: Available upon request

**ELEPHANT DOORS:**  
Four entrances approximately:  
15' Wide x 18' High  
Loading Height:  
Street Level & Loading Dock

**GOLD ROOMS:**  
2 Built-In

**HVAC:**  
Silent air conditioning and heating

**WATER:**  
On four perimeter walls  
Sink on south wall

\*Stage dimensions to be field verified

Downloadable PDF available at  
[www.foxstudiolot.com/stage](http://www.foxstudiolot.com/stage)

## FOX PRODUCTION SERVICES

10201 W. Pico Blvd, Los Angeles, CA 90064

310-FOX-INFO | [foxinfo@fox.com](mailto:foxinfo@fox.com) | [www.foxstudiolot.com](http://www.foxstudiolot.com)

™ & © 2019 Fox and its related entities. All rights reserved.

# FOX