

STAGE 22

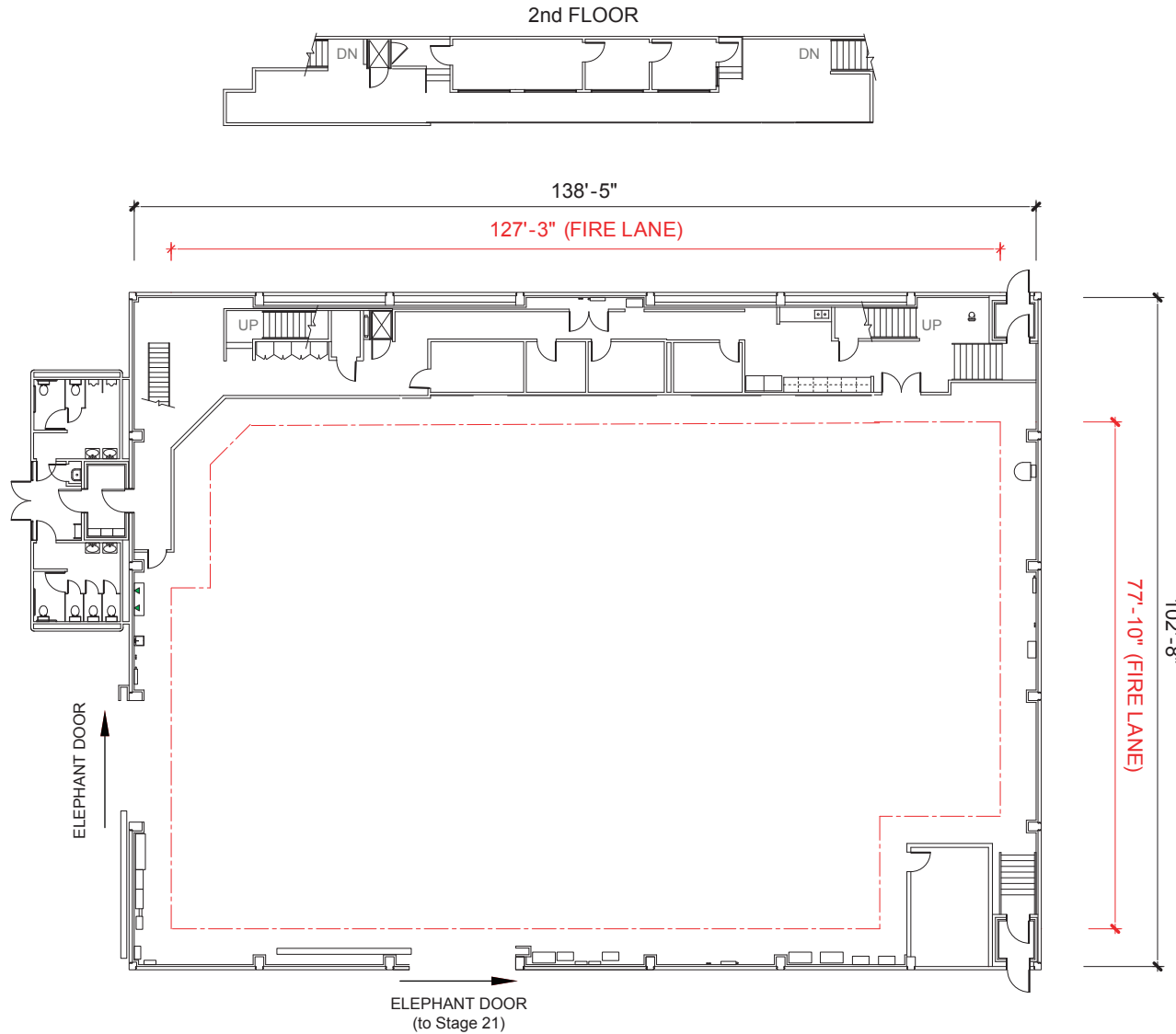

STAGE SIZE:

(102' x 138') 14,076 sq. ft.*
 Audience rated A-3
 Maximum crew & audience = 299
 Bleacher Package available

LIVE LOAD CAPACITY OF FLOOR:

Wood floor over concrete

HEIGHT:

35' to the permanents with catwalks above

BUILT-IN ROOMS:

Dimmer Room, Camera Room, Sound Booth, Dimmer Board Room, Green Room, 4 Support Rooms

AUDIENCE CAPACITY:

Approx. 175

FALL PROTECTION:

100% Tie-off Horizontal Lifeline system

ELECTRICAL:

A.C. Prod. Lighting: 500 KVA Transformer
 120/208 volts
 1-400 amp & 2-800 amp bull switches
 4800 total amps

Basic House/Building Power: 600 amps
 120/240 volts
 Single Phase

AC Spider: 225 amps
 120/240 volts
 Single Phase from
 Basic House Power

Power for Equipment: 3 Phase:
 350 amps
 240 volts**
 **Local 40 tie-in required

D.C. Lighting: Available upon request

ELEPHANT DOORS:

Two doors:
 16' Wide x 14' High (interior door)
 18' Wide x 24' High

HVAC:

Silent air conditioning

WATER:

On three perimeter walls
 Sink on west wall

*Stage dimensions to be field verified

Downloadable PDF available at
www.foxstudiolot.com/stage

FOX PRODUCTION SERVICES

10201 W. Pico Blvd, Los Angeles, CA 90064

310-FOX-INFO | foxinfo@fox.com | www.foxstudiolot.com

™ & © 2019 Fox and its related entities. All rights reserved.

FOX