

STAGE 21

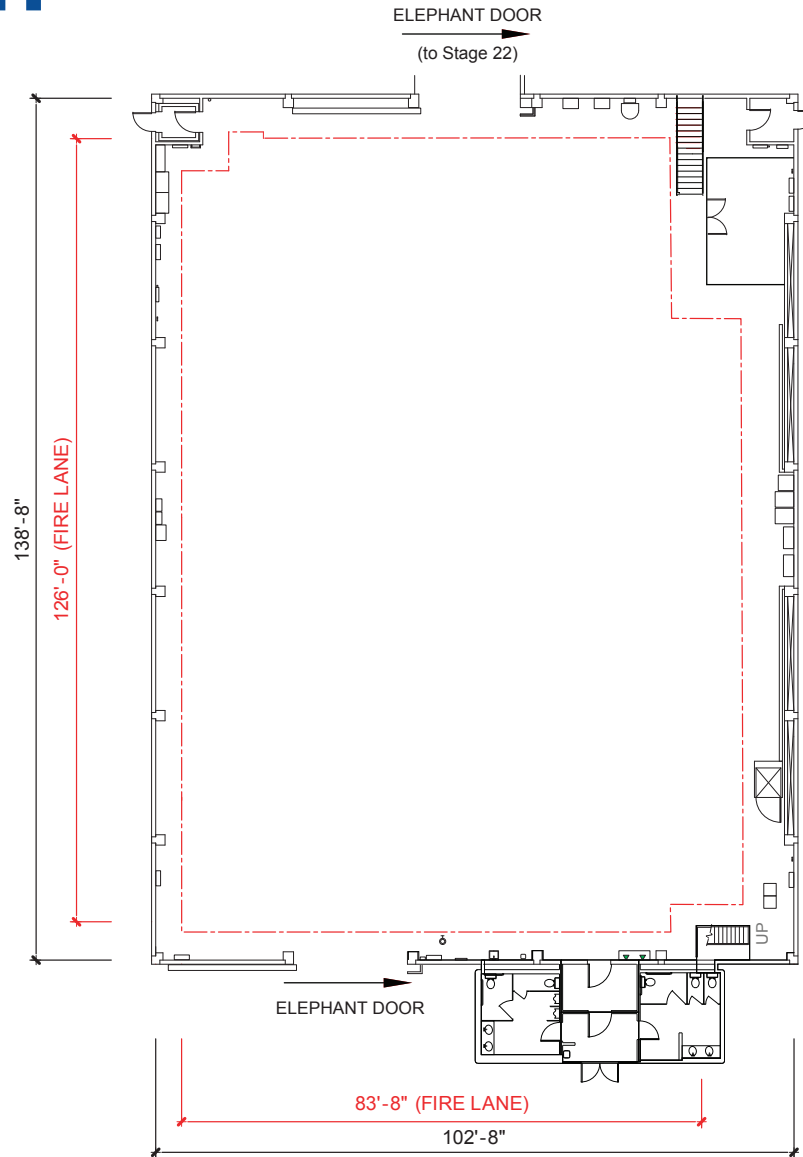

STAGE SIZE:

(102' x 138') 14,076 sq. ft.*

Audience rated A-3

Maximum crew & audience = 299

LIVE LOAD CAPACITY OF FLOOR:

Wood floor over concrete

HEIGHT:

35' to the permanents with catwalks above

BUILT-IN ROOMS:

6 Dressing Rooms each with private restroom (two handicapped), Hair/Make-up Room, 2 Wardrobe Rooms, 2 Prop Rooms, 2 Set Dressing Rooms, 2 Dimmer Rooms, 2 Sound Booths, Camera Room, 2 AD Rooms, Green Room, Electric Room, Grip Room, Full Crafts Service area

AUDIENCE CAPACITY:

Approx. 198

FALL PROTECTION:

100% Tie-off Horizontal Lifeline system

ELECTRICAL:

A.C. Prod. Lighting: 750 KVA Transformer
120/208 volts
4-400 amp bull switches
3840 total amps

Basic House/Building Power:

600 amps /120/240 volts
Single Phase

AC Spider: 225 amps / 120/240 volts
Single Phase from Basic House Power

Power for Equipment: 3 Phase:
350 amps / 240 volts**

**Local 40 tie-in required

D.C. Lighting: Available upon request

ELEPHANT DOORS:

Two doors approximately:
16' Wide x 14' High (interior door)
18' Wide x 24' High

HVAC:

Silent air conditioning

WATER:

On four perimeter walls

Sink on south wall

Full sink in Crafts Service Area

*Stage dimensions to be field verified

Downloadable PDF available at
www.foxstudiolot.com/stage

FOX PRODUCTION SERVICES

10201 W. Pico Blvd, Los Angeles, CA 90064

310-FOX-INFO | foxinfo@fox.com | www.foxstudiolot.com

™ & © 2019 Fox and its related entities. All rights reserved.

FOX