

STAGE 14

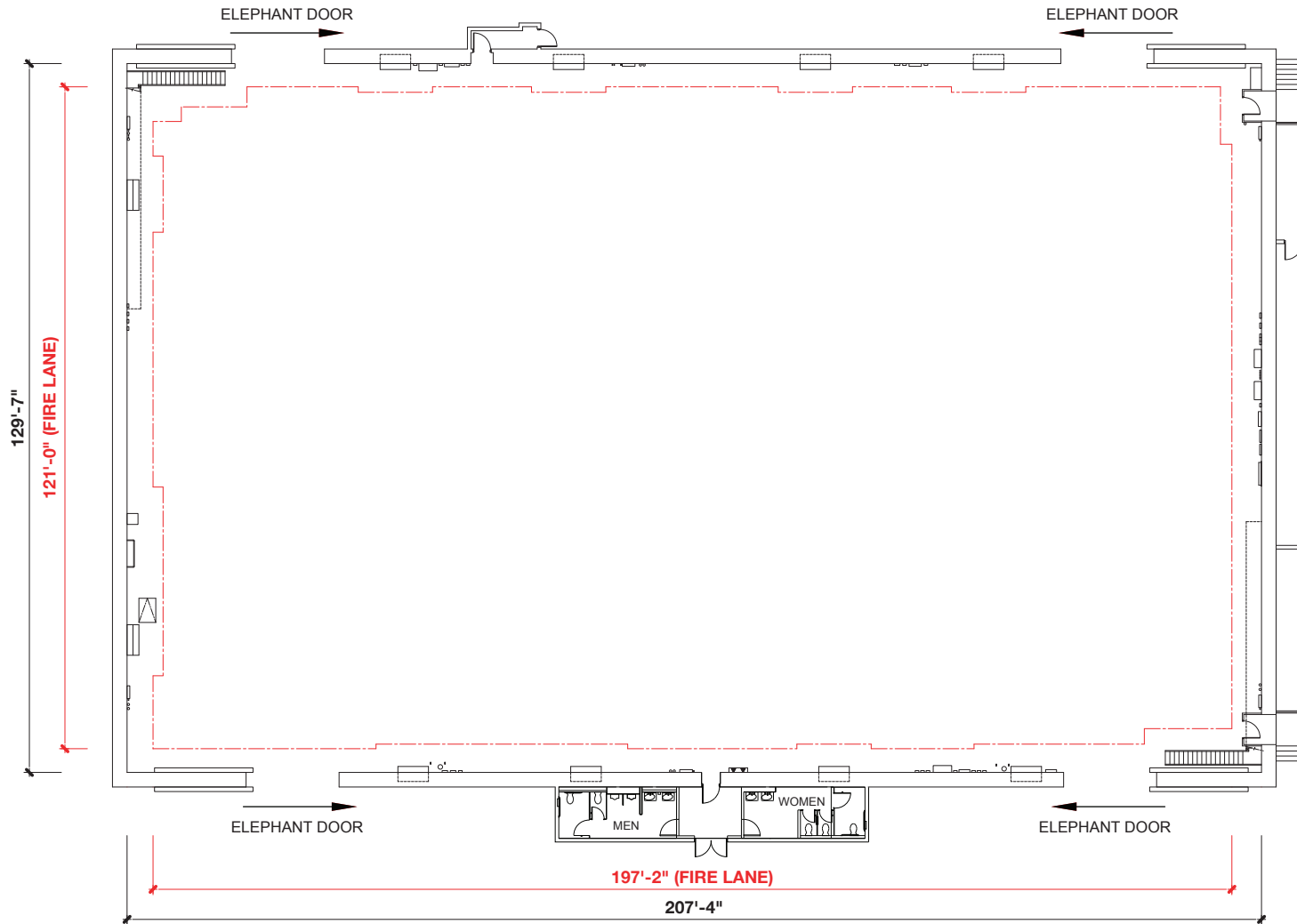

STAGE SIZE:
(130' x 207') 26,910 sq. ft.*

LIVE LOAD CAPACITY OF FLOOR:
Uniform Distribution = 250 PSF
Concentrated on Min. 2' x 2' area = 3500 lbs.
(Engineered Drawings Available Upon Request)

HEIGHT:
40' to the permanents with catwalks above

FALL PROTECTION:
100% Tie-in Horizontal Lifeline system

ELECTRICAL:
A.C. Prod. Lighting: 9000/3000 amps[†]
Basic House/Building Power: 400 amps
120/240 volts
Single Phase
Power for Equipment: 3 Phase:
200 amps
240 volts**
**Local 40 tie-in required

D.C. Lighting: Available upon request

ELEPHANT DOORS:
Four entrances each approximately:
16' Wide x 22' High
Loading Height:
Street Level & Loading Dock

HVAC:
Silent air conditioning and heating

WATER:
On four perimeter walls

[†] Maximum Load

*Stage dimensions to be field verified

Downloadable PDF available at
www.foxstudiolot.com/stage

FOX PRODUCTION SERVICES

10201 W. Pico Blvd, Los Angeles, CA 90064

310-FOX-INFO | foxinfo@fox.com | www.foxstudiolot.com

™ & © 2019 Fox and its related entities. All rights reserved.

FOX