

STAGE 6

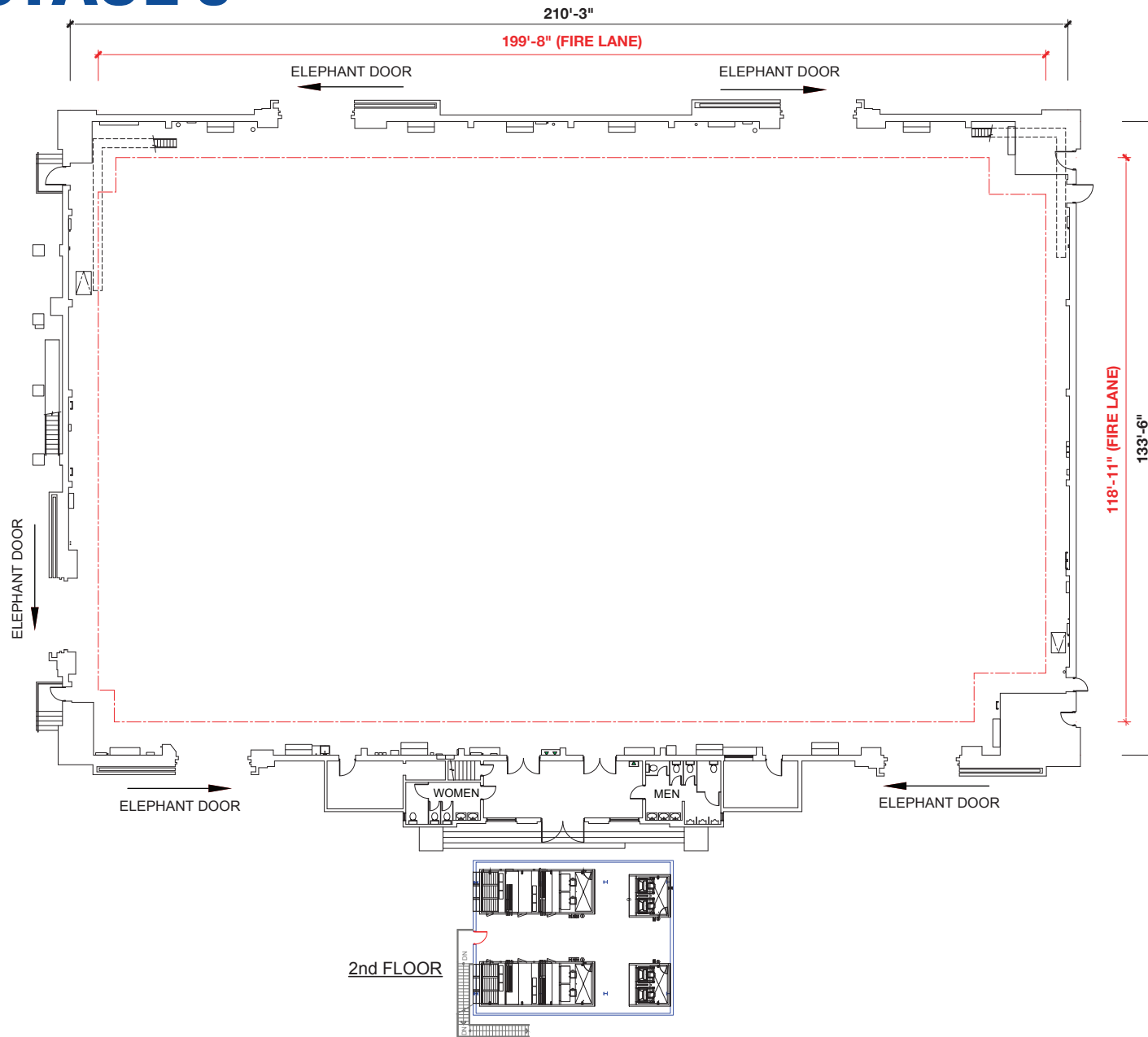

STAGE SIZE:

(134' x 210') 28,140 sq. ft.*

LIVE LOAD CAPACITY OF FLOOR:

Uniform Distribution = 200 PSF
 Concentrated on Min. 2' x 2' area = 2000 lbs.
 (Engineered Drawings Available Upon Request)

HEIGHT:

40' to the permanents with catwalks above

FALL PROTECTION:

100% Tie-off Horizontal Lifeline system

ELECTRICAL:

A.C. Prod. Lighting: 9000/3000 amps
 120/208 volts

Basic House/Building Power: 200 amps
 120/240 volts
 Single Phase

Additional Build Power at

A.C. Spider: 200 amps
 120/240 volts

Power for Equipment: 200 amps
 240 volts
 3 Phase**

**Local 40 tie-in required

D.C. Lighting: Available upon request

ELEPHANT DOORS:

Five entrances approximately:
 15' Wide x 18' High
 Loading Height:
 Street Level & Loading Dock

GOLD ROOMS:

2 Built-In

HVAC:

Silent air conditioning and heating

WATER:

On four perimeter walls
 Sink on south wall

*Stage dimensions to be field verified

Downloadable PDF available at
www.foxstudiolot.com/stage

FOX PRODUCTION SERVICES

10201 W. Pico Blvd, Los Angeles, CA 90064

310-FOX-INFO | foxinfo@fox.com | www.foxstudiolot.com

